

Step 1

- Remove F1 panel using hex wrench
- After removing 4 hex bolts, gently pry up panel using a plastic pry tool. Panel is also held in place with a few tabs that can be pried up carefully. Be careful not to damage leather around panel
- See 4 hex bolt locations in image below



Step 2

- After the F1 panel is loose, lift it back and reach under to loosen the wiring harness. The main wire feeding the "R" button and "Auto" button is zip tied to a frame below, but can easily be wiggled loose to give more slack.
- Once you can flip the F1 panel over, there are 2 small screws that hold the "R" housing in place. Remove the 2 screws and pull the housing back. You will see how the rubber button can now be accessed. Remove old button by slowly pulling it back with your fingers at the lip and replace with new button. Screw the housing back into place.
- See images below on how the housing looks and the button placement

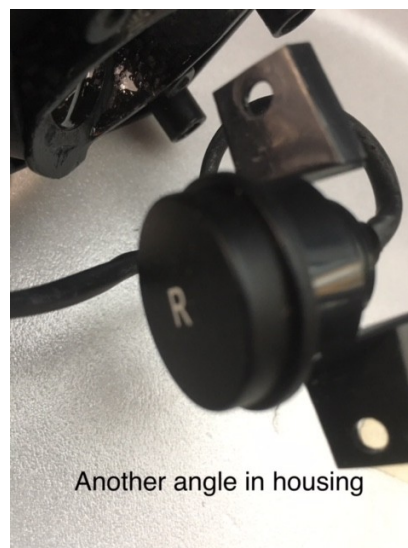

Step 3

- Remove housing for “Auto” button and follow same steps as “R” button in Step 2

Step 4

- After buttons have been replaced, tuck main harness wire back into place and snug F1 panel back into location
- Reinstall hex bolts
- Image below is finished installation before replacing bolts

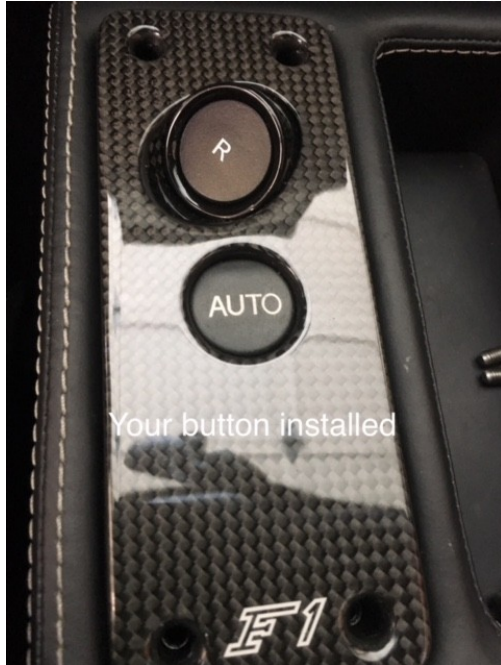

Needed Tools

- Metric hex wrench
- Philip head screw driver
- Plastic pry tool